



Other models available upon request. Specifications are subject to change without prior notice.

E1W INDUSTRIAL GLAND / E1FW FLAMEPROOF "D" GLAND

Application

For use with all types of unarmoured cables where it is essential to provide an IP66 or explosion proof seal on to the outer sheath.

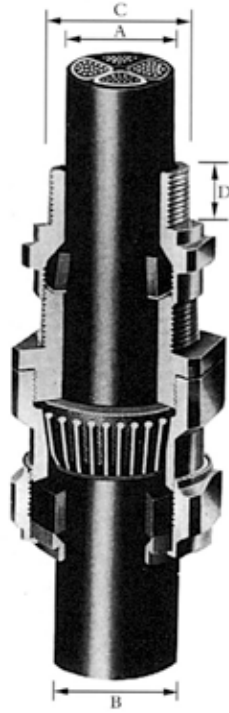

Gland Ref & Size	Termination Thread Size		Minimum Length of Thread "D"	Cable Diameter	
	"C"			Dia. Inner Sheath Max "A"	Dia. Outer Sheath Max "B"
	Metric	Imp.			
E1W	16L	5/8	10	9.0	14.5
E1W	20S	3/4	10	12.0	18.0
E1W	20L	3/4	10	15.0	20.8
E1W	25S	1	10	17.0	23.0
E1W	25L	1	10	20.0	28.0
E1W	32L	1 1/4	10	26.0	34.0
E1W	40S	1 1/2	15	29.0	37.0
E1W	40L	1 1/2	15	32.5	41.5
E1W	50S	2	20	38.0	46.5
E1W	50L	2	20	40.0	51.0
E1W	63S	2 1/2	20	45.0	57.0
E1W	63L	2 1/2	20	48.0	59.0
E1W	75S	3	20	54.0	66.0
E1W	75L	3	20	62.0	72.0
E1W	88S	3 1/2	25	67.0	80.0
E1W	88L	3 1/2	25	73.0	86.0

HIGH-TENSION CABLE CLAMP

Material: Aluminium Alloy BS 1490

Diameter Size: (50-60mm)

Diameter Size: (60-70mm)

Diameter Size: (70-80mm)

Diameter Size: (80-90mm)

Diameter Size: (90-100mm)

Diameter Size: (100-110mm)

Made to measure

Cat.No. HS 900

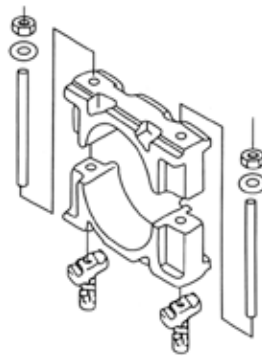
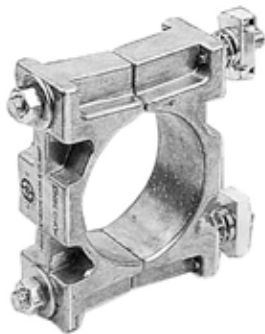

CAST IRON & ALUMINIUM ALLOY HIGH TENSION CABLE CLAMP

Size	Cat.No.
80 - 90	HS 513
90 - 100	



Other models available upon request. Specifications are subject to change without prior notice.



MATERIALS: Nylon PA 66 (Flammability UL 94 V-2) for A.C.E.F parts, EPDM rubber for B.D parts

COLOURS: Standard in black and gray

WORKING TEMP.: -40°C to 80°C, for short durations at 100°C

INSTALLATION: Time saving, cable can be easily inserted into the gland without dismantling the parts

CLAW: The claws and seals are designed to hold firmly and have a wider cable range

FEATURES: Resistant to salt water, weak acid, alcohol, oil, grease and common solvency.

Code	Cable Range	Thread O.D. C1	Panel Mounting Hole	Thread Length C2	Spanner Size A & F	Pkg
PGA7	8~4.6	12.5	12.5~12.8	8.5	17/19	50
PGA9	8~4.6	15.2	15.2~15.5	9	22/19	50
PGA11	10~6	18.6	18.6~18.9	10	24/22	50
PGA13.5	12~7	20.4	20.4~20.7	10	27/24	50
PGA16	14~9	22.5	22.5~22.8	11	30/27	50
PGA21	18~13	28.3	28.3~28.7	12.5	36/33	50
PGA29	25~18	37	37~37.4	12.5	46/41	10
PGA36	30~24	47	47~47.4	15	57/50	10
**PGB42	41~30	54	54~54.4	15.5	64/62	10
**PGB48	45~35	59.3	59.3~59.7	15.5	70/65	10

NOTE: For order of (**) item, please consult our sales team for technical clarifications.

